



**INFERNO™**

## Flame Heater

### FEATURES:

- The ideal solution for extending the season of outdoor entertaining
- Direct ignition
- Maximum output 36MJ/h
- Adjustable heat output
- Operates for approximately 9 hours on a properly filled 9Kg propane cylinder
- Includes a safety 'tip-over' switch that halts supply of gas to the unit should it be accidentally knocked over
- Flame safeguard system for enhanced safety
- Durable and weather resistant
- Complete with hose and regulator
- For outdoor use only
- AGA Certified

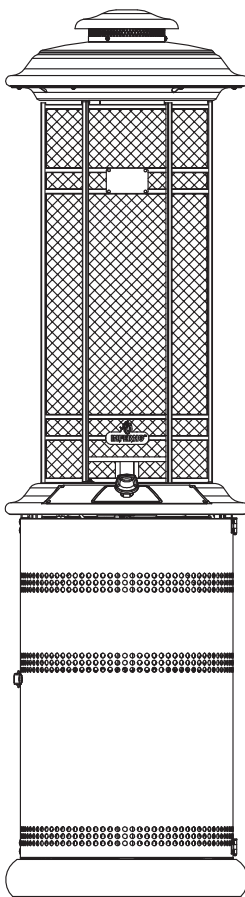

### FHIN100 SERIES

#### FOR YOUR SAFETY

If you smell gas:

1. Shut off the gas to the appliance.
2. Extinguish any open flame.
3. If odour continues, immediately call your gas supplier.

Do not store or use gasoline or other flammable vapour and liquids in the vicinity of this or any other appliance.

#### WARNING:

Improper installation, adjustment, alteration, service or maintenance can cause injury or property damage.

Read the instructions thoroughly before installing or servicing this equipment.

#### FOR OUTDOOR USE ONLY

#### PROPANE GAS

**Retain these instructions for future use**

---

**Important:** The installer or seller must leave these instructions with the consumer.

---

# INSTALLATION, OPERATION & MAINTENANCE INSTRUCTIONS

## INSTALLATION

### Important Safety Rules

This appliance must only be used in a well ventilated area.

1. This appliance shall not be installed or used indoors, in buildings, garages or any other enclosed area.
2. **DO NOT** place articles on or against this appliance.
3. **DO NOT** use or store flammable materials near this appliance.
4. Children and adults should be alerted to the hazards of high surface temperatures, burns and clothing ignition.
5. Children should be carefully supervised when they are in the area of the appliance.
6. **NEVER** hang anything including clothes or other flammable items on the appliance.
7. **DO NOT** operate this appliance unless it is fully assembled.
8. **DO NOT SPRAY AEROSOLS IN THE VICINITY OF THIS APPLIANCE WHILE IT IS IN OPERATION.**
9. Installation and repair should be done by a qualified service person. The appliance must be inspected before use and at least annually by a qualified service person. More frequent cleaning may be required as necessary. It is imperative that control compartment, burners and circulating air passages of the heater and light be kept clean.

3. Proper clearance from combustible materials must be maintained at all times. The minimum clearances are as follows:

Minimum Clearance from Combustibles:

Side: 500 mm

Rear: 500 mm

Ceiling: 500 mm

Combustible materials are considered to be wood, compressed paper, plant fibres, plastic, plexiglas or other materials capable of being ignited and burned.

Such materials shall be considered combustible even though flame proofed, fire-retardant treated or plastered. Additional clearance may be required for glass, painted surfaces and other materials which may be damaged by radiant or convection heat.

4. Heaters must be placed on a level and adequate footing and be readily accessible.
5. The gas manifold supply pressure must be regulated at 2.75 kPa utilising an AGA approved regulator (supplied with heater).
6. The appliance must be inspected before each use, and at least annually by a qualified service person.
  - a. The appliance area must be kept clear and free of combustible materials, gasoline and other flammable vapours and liquids.
  - b. Gas orifices and burner must be kept clear of dirt and cobwebs. Flow of combustion and ventilation air through the perforated portions of the heater must not be obstructed. Cleaning with a soft brush before use and at least every six months is recommended.
  - c. All gas connections should be checked for leaks utilising a soap solution. Never use a flame for this purpose.
  - d. The flame should be visually checked whenever heater is operated. If flames extend beyond surface of the chimney or black spot is accumulating on the burner or glass, the heater should be turned off immediately. The heater should not be operated again until the unit is serviced and or repaired.

Prior to assembling your appliance, the following must be reviewed. Compliance with the following should result in satisfactory heater operation. This instruction manual should be retained for future reference. The installation must conform with local codes or authority having jurisdiction.

1. The appliance is intended for heating residential and non-residential outdoor spaces. The installation must conform with local codes or, in the absence of local codes, with the Australian Standard AS 5601.
2. Adequate clearance around air openings into the combustion chamber, clearances from combustible materials, provisions for accessibility and for combustion and ventilating air supply must be maintained at all times when the appliance is operating.

- e. Any cleaning agent used on the appliance should be of a non-combustible and non-corrosive nature.
- 7. The hose assembly should be properly located out of pathways where people may trip over it. The hose must be protected from contact with hot or sharp surfaces both during use and while in storage. The hose assembly should be visually inspected prior to each use of the heater. If excessive abrasion or wear is evident, or the hose is cut, it must be replaced prior to operating the heater. The replacement hose assembly may be obtained from the manufacturer.
- 8. DO NOT use any pressure regulator or hose assembly other than those supplied with the appliance. Replacement pressure regulator and hose assembly must be those specified. Replacement parts may be obtained from the manufacturer or your local sales representative.
- 9. Installation and use of this appliance must conform with local codes or, in the absence of local codes, with the Standards of Storage and Handling of Liquefied Petroleum Gases.
- 10. This appliance is designed to operate with a standard 9Kg propane cylinder with Approved Cylinder Connection.
- 11. The valve outlet must be maintained in good condition. When the cylinder is not in use, be sure to cover it with a dust cap. A leak test should be performed with soapy water whenever connecting a new cylinder. **NEVER** use a match to test for leaks.
- 12. The propane cylinder must be turned off whenever the heater is not in use. When the heater is to be stored indoors, the propane cylinder and the heater must be disconnected and the cylinder stored in accordance with the Standard for Storage and Handling of Liquefied Gases. (i.e.: Not indoors, but in a dry and well ventilated area.)
- 13. The heater has been designed with several safety features which include a tip over switch.

Any modification to the heater not described in the installation instructions may compromise the safety of this appliance. Special concern is as follows:

DO NOT bypass thermocouple safety;

Clothing or other flammable materials should not be hung from the heater, or placed on or near the heater. The area above may be extremely hot. Direct contact with these metal surfaces should be avoided in order to prevent burns or clothing ignition.

### POL CYLINDER CONNECTION DEVICE

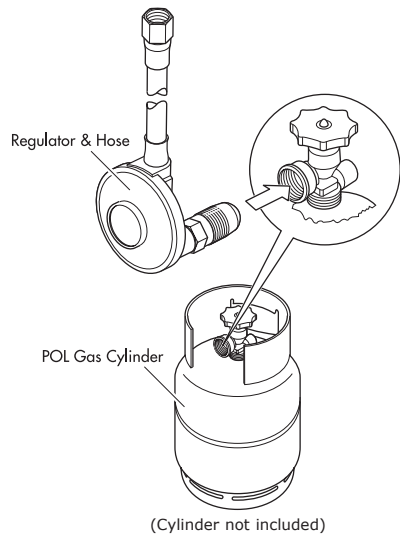

Screw the coupling nut of regulator into the cylinder valve outlet.

Type of Gas	Propane
Consumption	36 MJ/h
Operating Pressure	2.75 kPa
Injector Size	1.7 mm

Heater specifications can be found on the data label.

# PARTS & CONTENTS

Weather resistant heat reflector prevents water from entering the combustion zone and reflects heat down.

Chimney cover

Safety guard protects the full height of the heat exchanger tube.

Heat exchange tube has a large heat-radiating surface.

Gas control with electronic igniter is centrally positioned for easy access.

A hinged metal door is provided for easy access to the LP gas cylinder.

Integrated wheels allow for easy transport.

The large base ensures good stability.

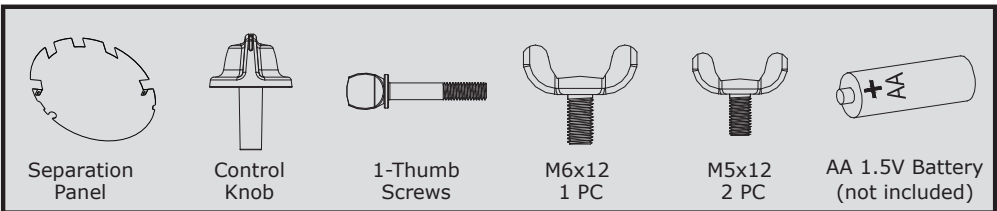
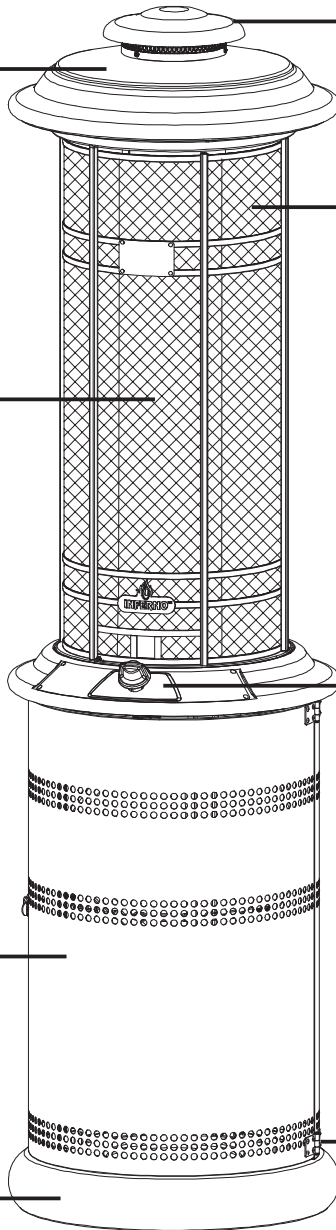

# ASSEMBLY INSTRUCTIONS

Remove any transit protection material.

## STEP 1

To assemble unit, partially open gas chamber door. Carefully lift heat reflector until entire heat exchange tube is exposed.

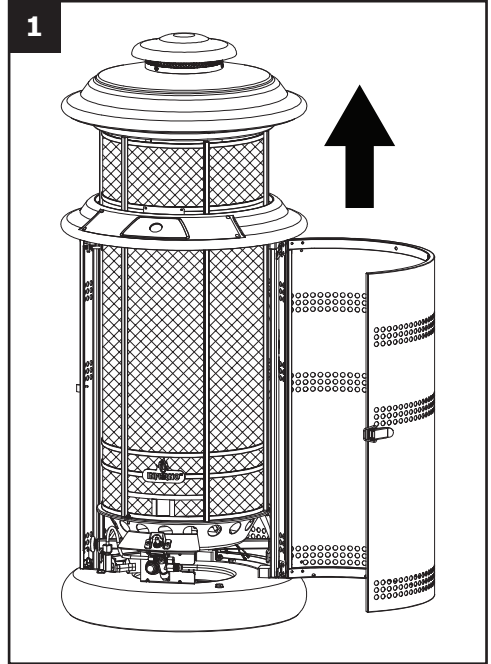

## STEP 2

After heat exchange tube is fully extended, rotate counter-clockwise until it stops.

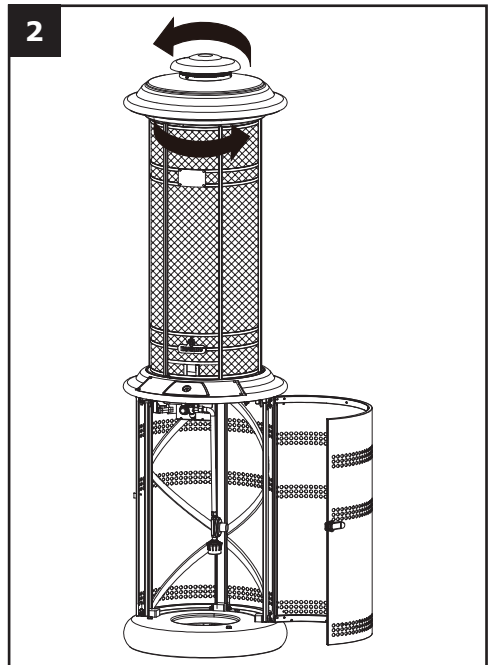

### STEP 3

Fully open gas chamber door. Remove knob from door and place on control stem.

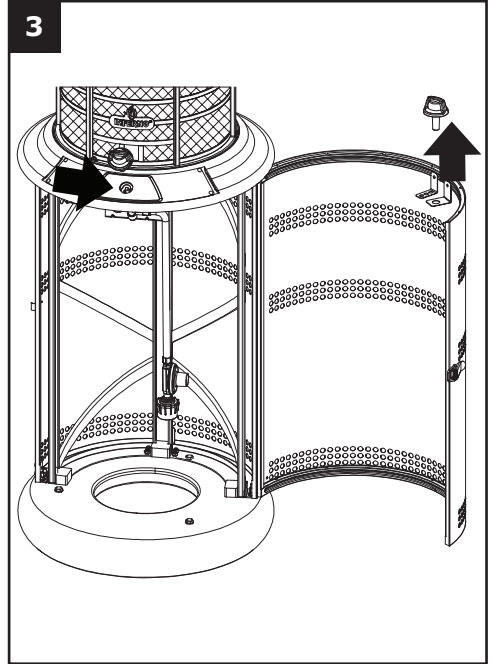

### STEP 4

Locate (2) holes to lock heat exchange tube in place. Secure with (2) included wing screws.

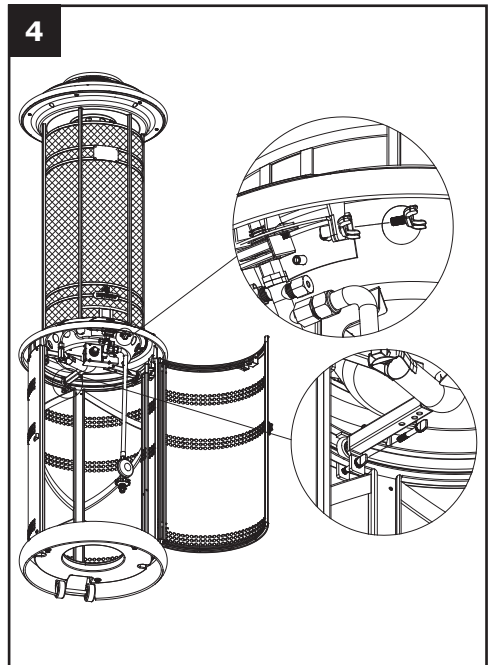

## STEP 5

Locate automatic igniter under control panel. Unscrew igniter cap and insert a 1.5V AA battery (not included).

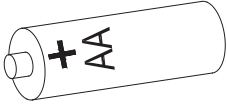

AA 1.5V Battery  
(not included)

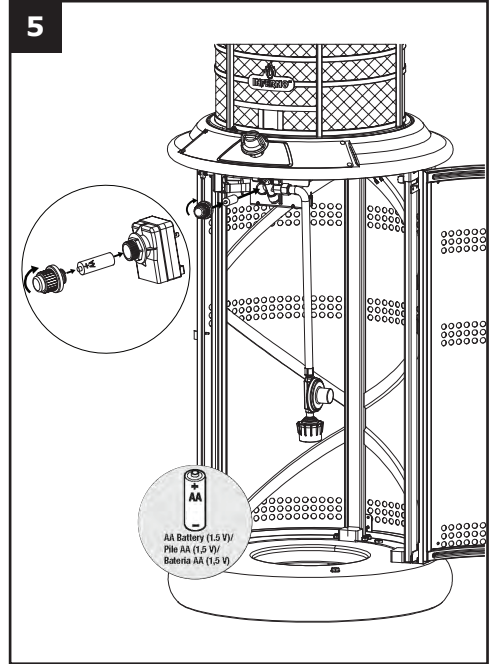

## STEP 6

### Installing the Separation Panel

- Holding the panel on both sides with the bent tabs facing downwards, flex the panel sides upwards forming the panel into a concave curve.
- Align the panel central rear slot with the vertical upright beam in the cylinder compartment just above the upper most rows of ventilation holes and manoeuvre it into position ensuring that all of the panel cut outs align with the corresponding beams.
- Attach the panel to the side beams using two wing screws through the bent tabs.
- Ensure the hose is located into the split rubber grommet.

### DO NOT USE HEATER UNTIL PANEL IS INSTALLED.

Connect the regulator to the gas cylinder then turn gas on and check for leaks using a soapy water solution.

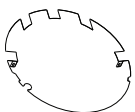

Separation  
Panel



M5x12  
2 PC

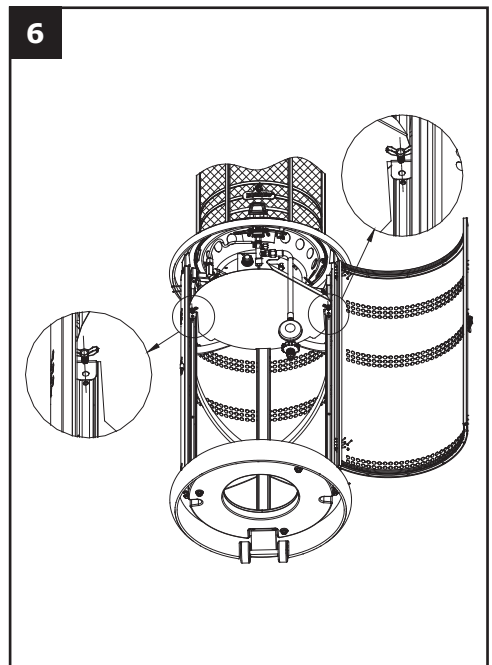

# OUTDOOR FLAME HEATER - FOR OUTDOOR USE ONLY

## Minimum Clearance from Combustible Surfaces\*:

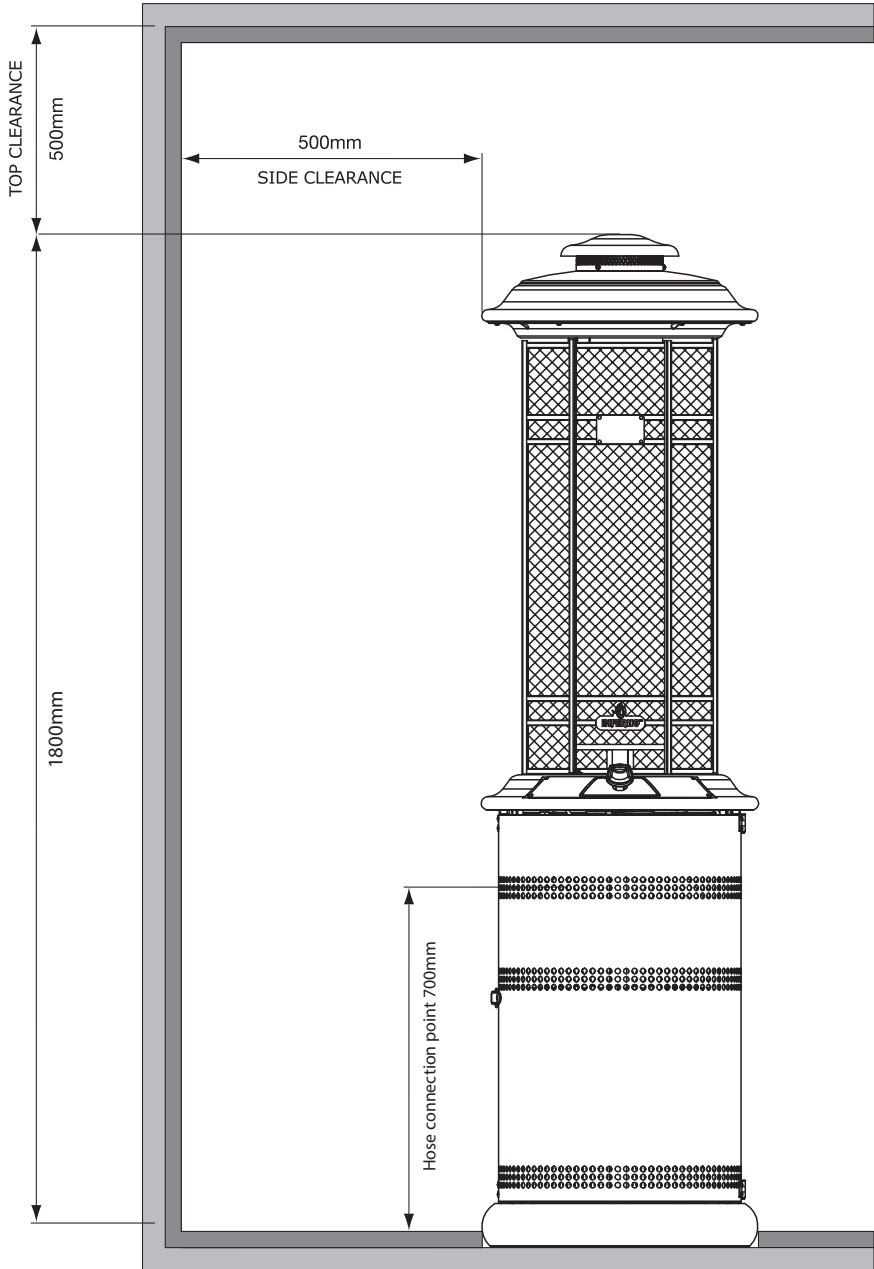

\*Combustible materials are considered to be wood, compressed paper, plant fibres, plastic or other materials that are capable of being ignited and burned.



## TEST FIRING HEATER

Test fire heater, following the lighting instructions. Leak test all gas connections with soapy water. Soap bubbles indicate gas leakage. DO NOT use a match to test for gas leaks.

Warning: White smoke may appear during the first minute of the initial firing.

Note: If the appliance cannot be adjusted to perform correctly it should not be used until serviced or repaired.

## TROUBLE SHOOTING

Problem	Possible Causes
Appliance won't light	No gas
	Low gas pressure
	Blockage in orifice
	Manual valve not in 'LOW' or 'HIGH' position

Warning: Improper installation, adjustment, alteration, service or maintenance can cause injury or property damage.

Any modifications or adjustments made to product without prior authority from the manufacturer will void any warranty claims. Read the installation, operating and maintenance instructions thoroughly before installing or servicing this equipment.

## LIGHTING INSTRUCTIONS

### Step 1

Ensure that the control knob is off. Slowly open the gas cylinder valve.

### Step 2

Push in control knob and turn anti-clockwise to ignite. Hold knob in, a pulsating sound will be heard, watch for the pilot to light.

### Step 3

If pilot does not light immediately turn control knob to 'OFF' position and try again from the start. Allow 3 minutes between ignition attempts for gas to dissipate. Several attempts may be necessary.

### Step 4

For maximum heat push in and turn the control knob to 'HIGH'.

### Step 5

For minimum heat push in and turn the control knob to 'LOW'.

### Step 6

To turn heater off, turn the control knob to 'OFF', then turn the gas cylinder valve off.

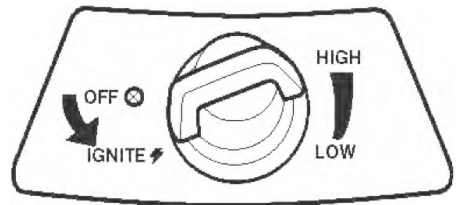

## SAFE APPLIANCE LOCATIONS

This appliance shall only be used in an above ground open-air situation with natural ventilation, without stagnant areas, where gas leakage and products of combustion are rapidly dispersed by wind and natural convection.

### Any enclosure in which the appliance is used shall comply with one of the following:

An enclosure with walls on all sides, but at least one permanent opening at ground level and no overhead cover (see Example 1).

Within a partial enclosure that includes an overhead cover and no more than two walls (see Example 2 & 3).

### Within a partial enclosure that includes an overhead cover and more than two walls, the following will apply:

at least 25% of the total wall area is completely open, and

at least 30% of the remaining wall area is open and unrestricted (see Example 4 & 5).

In the case of balconies, at least 20% of the total wall area shall be and remain open and unrestricted.

The following figures are diagrammatical representations of outdoor areas. Rectangular areas have been used in these figures - the same principles apply to any other shaped area.

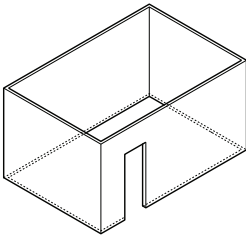

Outdoor Area - Example 1

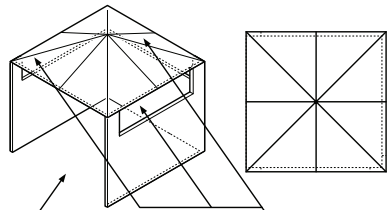
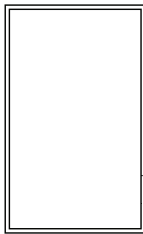

Open Side at least 25% of total wall area

30% or more in total of the remaining wall area is open and unrestricted

Outdoor Area - Example 4

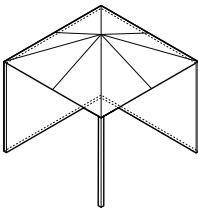

Outdoor Area - Example 2

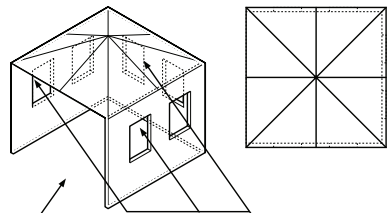
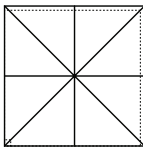

Open Side at least 25% of total wall area

30% or more in total of the remaining wall area is open and unrestricted

Outdoor Area - Example 5

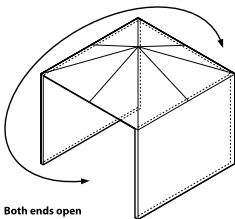

Both ends open

Outdoor Area - Example 3

