



# STELLAR BLACK DELUXE PATIO HEATER

Model No. PH7056 / PH7057

- The ideal solution for extending the outdoor entertaining season
- Direct ignition
- Maximum output 40MJ/h
- Adjustable heat output
- Includes wheels
- Operates for approximately 9 hours on a properly filled 9Kg propane cylinder
- Includes a safety 'tip-over' switch that halts supply of gas to the unit should it be accidentally knocked over
- Flame safeguard system for enhanced safety
- Complete with hose and regulator
- For outdoor use only
- Gas certified to Australian standards

## FOR YOUR SAFETY

If you smell gas:

1. Shut off the gas to the appliance.
2. Extinguish any open flame.
3. If odour continues, immediately call your gas supplier.

Do not store or use gasoline or other flammable vapour and liquids in the vicinity of this or any other appliance.

## WARNING

Improper installation, adjustment, alteration, service or maintenance can cause injury or property damage.

Read the instructions thoroughly before installing or servicing this equipment.

## FOR OUTDOOR USE ONLY PROPANE GAS



---

Important: Retain these instructions for future use.

# Installation, Operation and Maintenance Instructions

## INSTALLATION

### Important Safety Rules

This appliance must only be used in a well ventilated area.

1. This appliance shall not be installed or used indoors, in buildings, garages or any other enclosed area.
2. **DO NOT** place articles on or against this appliance.
3. **DO NOT** use or store flammable materials near this appliance.
4. Children and adults should be alerted to the hazards of high surface temperatures, burns and clothing ignition.
5. Children should be carefully supervised when they are in the area of the appliance.
6. **NEVER** hang anything including clothes or other flammable items on the appliance.
7. **DO NOT** operate this appliance unless it is fully assembled with burner guard in place.
8. **DO NOT SPRAY AEROSOLS IN THE VICINITY OF THIS APPLIANCE WHILE IT IS IN OPERATION.**
9. Installation and repair should be done by a qualified service person. The appliance must be inspected before use and at least annually by a qualified service person. It is imperative that control compartment, burners and circulating air passages of the heater be kept clean.

Prior to assembling your appliance, the following must be reviewed. Compliance with the following should result in satisfactory heater operation. This instruction manual should be retained for future reference. The installation must conform with local codes or authority having jurisdiction.

1. The patio heater is intended for heating residential and non-residential outdoor spaces. The installation must conform with local codes and with the Australian Standard AS/NZS 5601.
2. Adequate clearance around air openings into the combustion chamber, clearances from combustible materials, provisions for accessibility and for combustion and ventilating air supply must be maintained at all times when the appliance is operating.

3. Proper clearance from combustible materials must be maintained at all times. The minimum clearances are as follows:

### Minimum Clearance from Combustibles:

<b>Side</b>	500 mm	<b>Rear</b>	500 mm
<b>Ceiling</b>	500 mm		

Combustible materials are considered to be wood, compressed paper, plant fibres, plastic, plexiglas or other materials capable of being ignited and burned.

Such materials shall be considered combustible even though flame proofed, fire-retardant treated or plastered. Additional clearance may be required for glass, painted surfaces and other materials which may be damaged by radiant or convection heat.

4. Heaters must be placed on a level and adequate footing and be readily accessible.
5. The gas manifold supply pressure must be regulated at 2.75 kPa utilising an AGA approved regulator (supplied with heater).
6. The appliance must be inspected before each use, and at least annually by a qualified service person.
  - a. The appliance area must be kept clear and free of combustible materials, gasoline and other flammable vapours and liquids.
  - b. Gas orifices and burner must be kept clear of dirt and cobwebs. Flow of combustion and ventilation air through the perforated portions of the heater must not be obstructed. Cleaning with a soft brush before use and at least every six months is recommended.
  - c. All gas connections should be checked for leaks utilising a soap solution. Never use a flame for this purpose.
  - d. The flame pattern should be visually checked whenever heater is operated. If flames extend beyond surface of the guard the appliance should be turned off and should not be operated again until the unit is serviced and or repaired.
  - e. Any cleaning agent used on the heater should be of a non-combustible and non-corrosive nature.
  - f. The stainless steel emitter normally does not require cleaning and should **NEVER** be painted.

7. The hose must be protected from contact with hot or sharp surfaces both during use and while in storage. The hose assembly should be visually inspected prior to each use of the heater. If excessive abrasion or wear is evident, or the hose is cut, it must be replaced prior to operating the heater. The replacement hose assembly may be obtained from the manufacturer.
8. **DO NOT** use any pressure regulator or hose assembly other than those supplied with the appliance. Replacement pressure regulator and hose assembly must be those specified. Replacement parts may be obtained from the manufacturer or your local sales representative.
9. Installation and use of this heater must conform with local codes and AS/NZS 5601.
10. This heater is designed to operate with a standard 9Kg propane cylinder with Approved Cylinder Connection.
11. The valve outlet must be maintained in good condition. When the cylinder is not in use, be sure to cover it with a dust cap. A leak test should be performed with soapy water whenever connecting a new cylinder. **NEVER** use a match to test for leaks.
12. The propane cylinder must be turned off whenever the heater is not in use. When the heater is to be stored indoors, the propane cylinder and the heater must be disconnected and the cylinder stored in accordance with the Standard for Storage and Handling of Liquefied Gases.
13. The patio heater has been designed with several safety features which include a tip over switch.

NOTE: The plastic container in the base must be filled with sand before use.

Any modification to the heater not described in the installation instructions may compromise the safety of this appliance. Special concern is as follows:

- (1) **DO NOT** shorten post length;
- (1) **DO NOT** bypass thermocouple safety;
- (2) **DO NOT** operate heater without the reflector;

Clothing or other flammable materials should not be hung from the heater, or placed on or near the heater. The area above the burner may be extremely hot. Direct contact with these metal surfaces should be avoided in order to prevent burns or clothing ignition.

## POL CYLINDER CONNECTION DEVICE

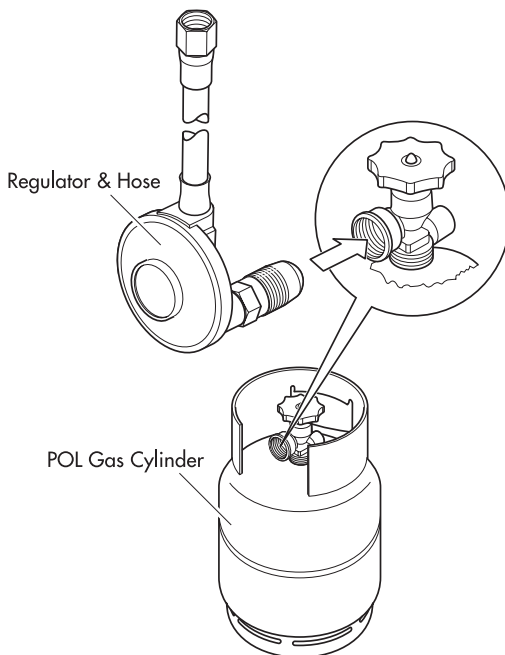

Screw the coupling nut of regulator into the cylinder valve outlet.

Type of Gas	Propane
Consumption	40 MJ/h
Operating Pressure	2.75 kPa
Injector Size	1.9 mm
PH7056 Colour	Black
PH7057 Colour	Graphite

Heater specifications can be found on the data label.

### **!** IMPORTANT

Storage of an appliance indoors with the cylinder attached is only permitted if the size of the cylinder complies with AS/NZS 1596; otherwise cylinders must be stored outdoors in a well ventilated area.

# PATIO HEATER - For Outdoor Use Only

## Minimum Clearance from Combustible Surfaces\*:

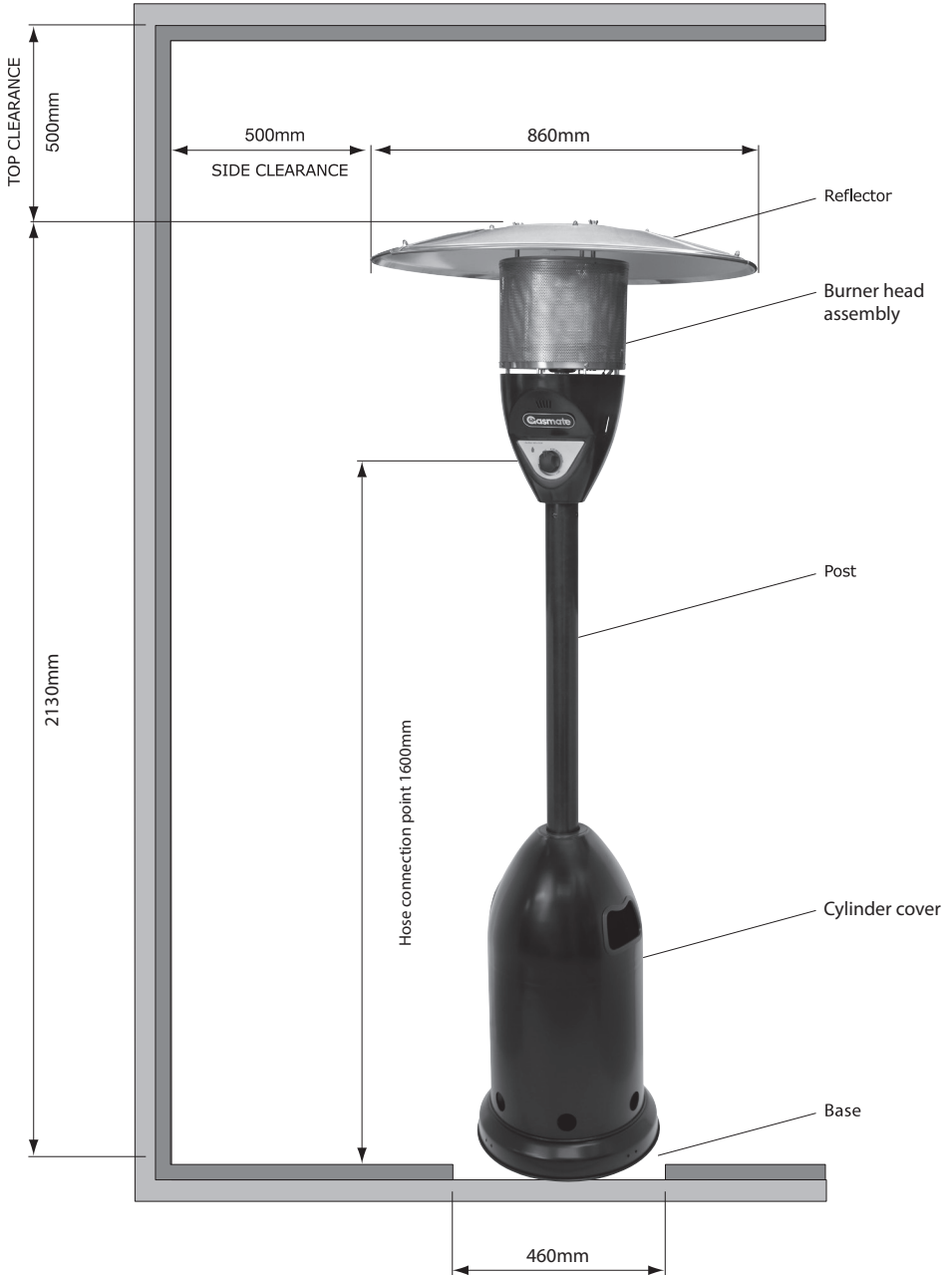

\*Combustible materials are considered to be wood, compressed paper, plant fibres, plastic or other materials that are capable of being ignited and burned.

# REFLECTOR ASSEMBLY

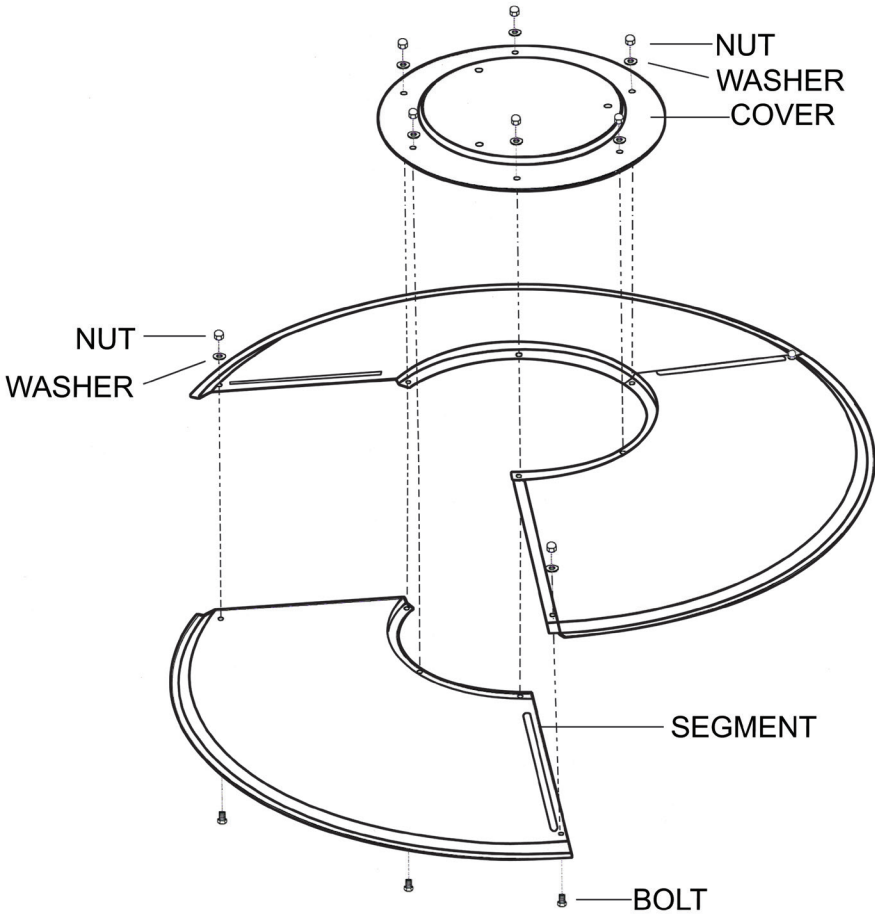

## STEP 1

Place the 3 parts of reflector segments to overlap together and attach with 3 screws, washers and nuts.

## STEP 2

Place round part of reflector over the 3 segments and attach with 3 screws, washers and nuts.

# PATIO HEATER ASSEMBLY

## Tools Required

Phillips head screwdriver

2 Adjustable spanners

**Note: Remove any transit protection material**

### STEP 1

Secure the post onto the post support with 6 screws, feed the hose up through the post and temporarily secure the end with tape to the post top.

### STEP 2

Slide the cylinder cover over the post.

### STEP 3

Secure the 3 reflector mounting studs to the burner head assembly.

### STEP 4

Feed the hose down the post. Secure the burner head assembly to the post using the 4 bolts and washers.

### STEP 5

Connect the regulator to the hose and tighten using 2 spanners.

### STEP 6

Connect the regulator to a gas cylinder and leak test the hose connection, then attach the burner head to the post with 4 screws.

### STEP 7

Place 3 washers onto the reflector mounting studs, position the reflector. Then place 3 more washers and secure with 3 nuts.

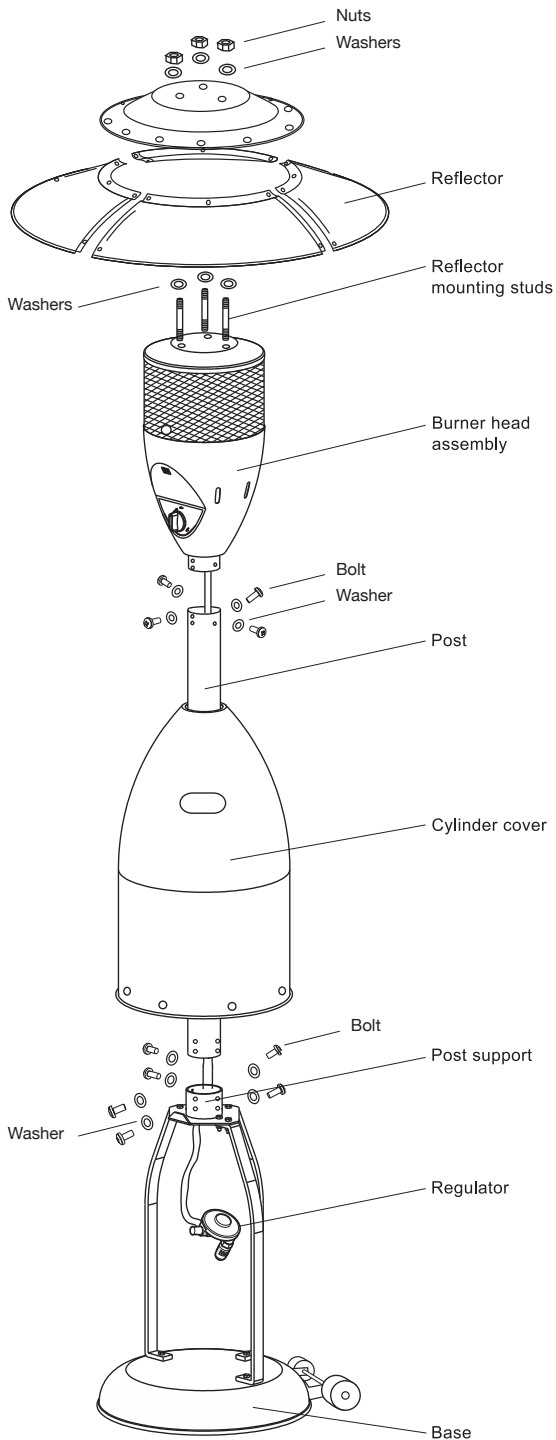

## TEST FIRING HEATER

Test fire heater, following the lighting instructions on heater post. Leak test all gas connections with soapy water. Soap bubbles indicate gas leakage. **DO NOT** use a match to test for gas leaks.

**WARNING:** White smoke may appear around the radiant head during the first minute of the initial firing.

## TROUBLE SHOOTING

Problem	Possible Causes	Solution
Main burner won't light	No gas	Replace cylinder
	Low gas pressure	Replace cylinder
	Blockage in orifice	Remove blockage
	Manual valve not in 'LOW' or 'HIGH' position	Position to 'HIGH'
	Exposure to rain	Remove emitter and clean burner ports

**NOTE:** If the appliance cannot be adjusted to perform correctly it should not be used until serviced or repaired.

**WARNING:** Improper installation, adjustment, alteration, service or maintenance can cause injury or property damage. Any modifications or adjustments made to product without prior authority from the manufacturer will void any warranty claims. Read the installation, operating and maintenance instructions thoroughly before installing or servicing this equipment.

## LIGHTING INSTRUCTIONS

**WARNING:** White smoke may appear around the radiant head during the first minutes of the initial firing.

1. Ensure that the control knob is off. Slowly open the gas cylinder valve.
2. Push in control knob and turn anti-clockwise to 'HIGH'
3. Check for flame at the burner. If burner does not light immediately turn control knob to 'OFF' position and try again from the start. Allow 30 seconds between ignition attempts for gas to dissipate. Several attempts may be necessary.

**Failure to follow this lighting procedure may result in flame roll out beyond the emitter grid.**

4. With the burner alight keep control knob depressed for 15 seconds.
5. For minimum heat push in and turn the control knob to 'LOW'.
6. To turn heater off, turn the control knob to 'OFF'.

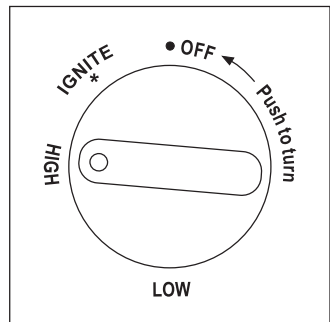
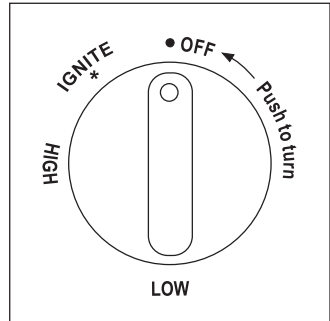

## SAFE APPLIANCE LOCATIONS

This appliance shall only be used in an above ground open-air situation with natural ventilation, without stagnant areas, where gas leakage and products of combustion are rapidly dispersed by wind and natural convection.

### Any enclosure in which the appliance is used shall comply with the following:

An enclosure with walls on all sides, but at least one permanent opening at ground level and no overhead cover (see Example 1).

Within a partial enclosure that includes an overhead cover and no more than two walls (see Example 2 & 3).

### Within a partial enclosure that includes an overhead cover and more than two walls, the following will apply:

At least 25% of the total wall area is completely open, and at least 30% of the remaining wall area is open and unrestricted.

In the case of balconies, at least 20% of the total wall area shall be and remain open and unrestricted (see Example 4 & 5).

The following figures are diagrammatic representations of outdoor areas. Rectangular areas have been used in these figures – the same principles apply to any other shaped area.

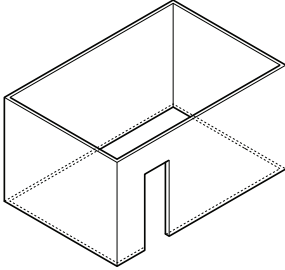

**Outdoor Area - Example 1**

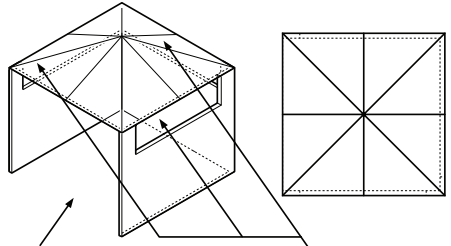
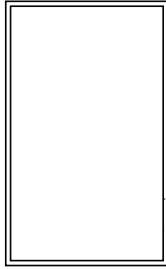

**Open Side at least 25% of total wall area**

30% or more in total of the remaining wall area is open and unrestricted

**Outdoor Area - Example 4**

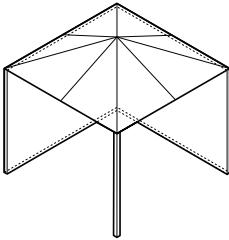

**Outdoor Area - Example 2**

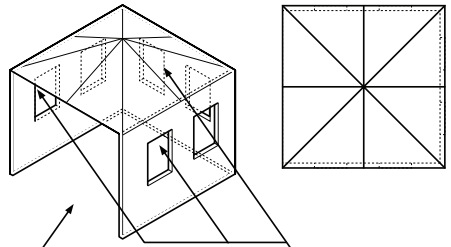
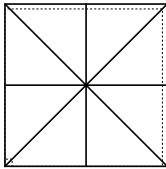

**Open Side at least 25% of total wall area**

30% or more in total of the remaining wall area is open and unrestricted

**Outdoor Area - Example 5**

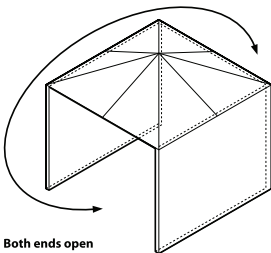

**Both ends open**

**Outdoor Area - Example 3**

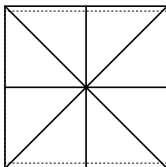

For any queries or assistance call:

**Customer Service**  
(Australia Only)

 **1300 174 876**

Hours of Operation: Mon to Fri 8am - 5pm EST

Do not return to place of purchase. Keep your purchase receipt, this will be required to make any claims under the 12 month warranty.